

Exhibit C
ORANGE COUNTY TRAFFIC COMMITTEE

COMMITTEE REPORT OF: April 17, 2008

ITEM B

SUPERVISORIAL DISTRICT: 5

SUBJECT: Speed Limit

LOCATION: La Pata Avenue; San Juan Capistrano; TB 952-H6, H7 & 972- H1

INITIATED BY: Traffic Engineering

INVESTIGATOR: Deepthi Arabolu

REQUEST: Establish Speed Limit

DATA:

LOCATION MAP:

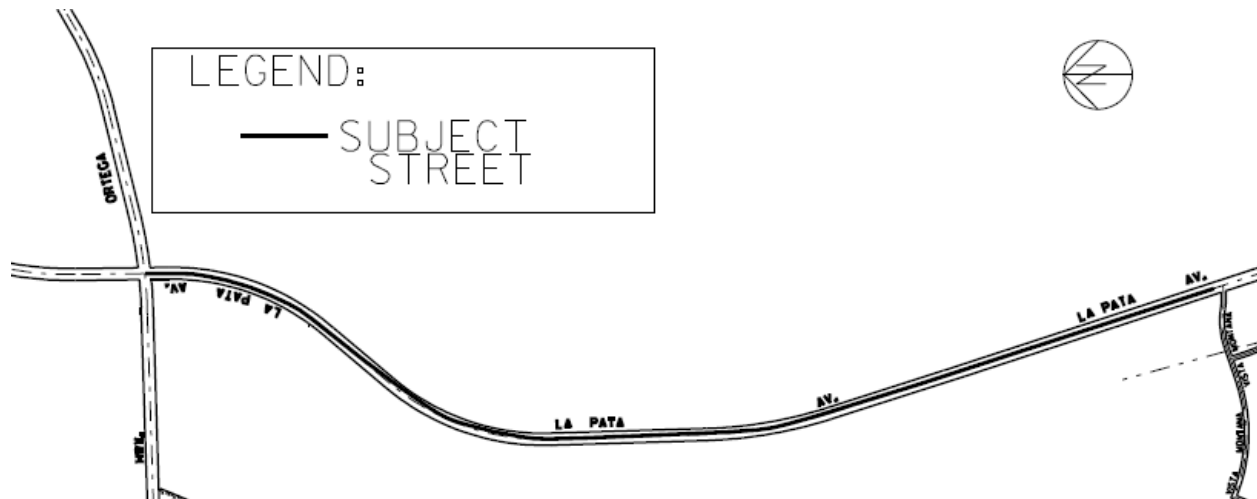

EXISTING CONDITIONS

La Pata Avenue between Ortega Highway and Vista Montana is a three lane divided roadway within the County's unincorporated area in the vicinity of San Juan Capistrano. Although classified as a Primary Arterial Highway according to the County's Master Plan of Arterial Highways, it is currently not built to ultimate widths. La Pata Avenue between Ortega Highway and Vista Montana traverses a hilly terrain, approximately 1.5 miles in length and is not fully improved with curb and gutter. The roadway is striped for two 12 foot south bound lanes (uphill)

COMMITTEE REPORT OF: April 17, 2008**ITEM B**

and one 12 foot north bound lane (downhill) with two 8 foot wide paved shoulders. Until last year, La Pata only served as access to the Prima Deshecha Landfill. The intersections of La Pata Avenue at Ortega Highway and La Pata Avenue at Vista Montana are both signalized. The landfill entrance is located at the south end of La Pata Avenue, beyond Vista Montana. Also, San Juan Hills High School is located on the west side of La Pata Avenue, north of Vista Montana. This school is the only public facility adjacent to the roadway. In addition to the Vista Montana intersection, there are 4 minor driveways accessing La Pata, 2 driveways on the west and east side of the street respectively. There are no residential units fronting the street. A new residential tract of homes is accessed off of Vista Montana, within the City. The landfill's refuse trucks are the predominant traffic on La Pata Avenue during non-peak periods. A 35 mph speed limit sign is currently posted on La Pata Avenue, originally placed when the road only served as landfill access. There are "No Stopping Any Time" signs posted along the entire length of the roadway, prohibiting parking.

TRAFFIC VOLUMES – 24 HOUR ADT

<u>Location</u> (Limits)	<u>Date</u>	<u>Direction</u>	<u>ADT</u> <u>Volume</u>	<u>Peak Hour</u>	
				<u>AM</u>	<u>PM</u>
La Pata Avenue (Ortega Hwy. & Vista Montana)	03/28/2007 *	NB/SB	2731	345	340

* Available traffic counts were conducted prior to school and homes being occupied.

SPOT SPEED DATA

<u>Location</u>	<u>Date</u>	85 th <u>Percentile</u> mph	10 MPH <u>Pace</u> mph	% <u>In Pace</u>	Total <u>Vehicles</u>
North of San Juan High School	4/8/2008	53	42-51	53	124

ACCIDENT DATA

Traffic Engineering's available records show 1 reported accident over the past 12 months on La Pata Avenue between Ortega Highway and Vista Montana. The accident rate calculated per million vehicle miles traveled per year is 0.61 while the State expected accident rate is 1.2.

ANALYSIS

As seen in the field, the current posted speed limit signage on La Pata Avenue between Ortega Highway and Vista Montana is 35 mph. This speed limit does not have a supporting Engineering and Traffic Survey. Hence an Engineering and Traffic Survey was conducted in accordance with the vehicle code requirements to evaluate the appropriate posted speed limit on La Pata Avenue. The results of the radar speed survey showed the measured 85th percentile speed was 53 mph. The 10 mph pace was 42 mph to 51 mph with 53% of surveyed drivers within the pace. The average speed of the drivers surveyed was 46 mph. The California Manual on Uniform Traffic Control Devices specifies that the speed limit based on an Engineering and Traffic survey be set at the nearest 5 mph increment to the 85th percentile speed. A 5 mph reduction may be taken based on specific conditions not readily apparent to the driver such as width, curvature, or other surface conditions. Staff did not observe any such roadway conditions. La Pata Avenue between these limits is in the process of being designed to its ultimate classification as a fully improved 4 lane divided roadway. Furthermore, the ultimate improvements of the roadway are planned for the year 2013. Therefore, based on the current speed survey data and roadway conditions, staff recommends a speed limit of 55 mph on La Pata Avenue between Ortega Highway and Vista Montana. Considering that the future lane configurations and roadway improvements will cause noticeable impact on traffic behavior, staff recommends another Engineering and Traffic Survey be conducted after the completion of the project.

TRAFFIC COMMITTEE DISCUSSION

The Committee inquired about the schedule of the future widening of the roadway to its ultimate classification. Also, the Committee asked staff to confirm the absence of pedestrians along the roadway. The Committee unanimously approved the recommendation of establishing a speed limit of 55 mph on La Pata Avenue between Ortega Highway and Vista Montana.

RECOMMENDATION

Establish a 55 mph "Radar Enforced" speed limit on La Pata Avenue between Ortega Highway and Vista Montana.

BOARD ACTION NECESSARY TO ENACT THIS RECOMMENDATION

1. Approve the report.
2. By Resolution, establish a 55 mph "Radar Enforced" speed limit on La Pata Avenue between Ortega Highway and Vista Montana.